



Quick Installation Guide

Long-range Outdoor Wireless Transmitter

WK-WB08-KIT

www.wireless-tek.com

1.Packing Content

•WK-WB08-KIT



Wireless Transmitter x 2



PoE Adapter x 2



Plastic Tie Cable x 2



Quick Installation Guide x 1

2.Hardware Overview

•WK-WB08-KIT

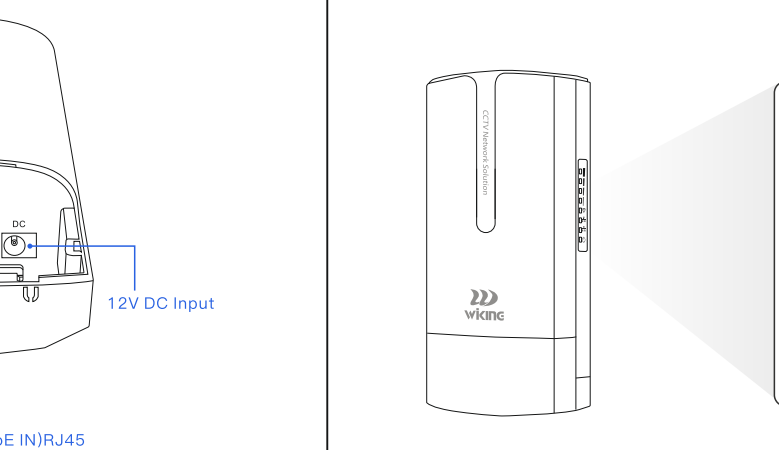

•Button

Button	Description
DIP Switch	H: Base station mode, supports wireless point-to-point and point-to-multipoint long-distance transmission. C: CPE mode, a receiving point for connecting a wireless base station.
Reset Button	Short press: Search for another wireless transmitter on a different mode (H/C status) and pair each other. The pair search will last for 120 seconds after short pressing the button. Long press over 5 seconds: Restore the factory default configuration.

3.Installation

- 1.Insert ribbon at the backside bracket hole.Adjust it according to the pole size and installation position.
- 2.Install the device on the pole and tighten the ribbon.
- 3.Hold on the buckle to take down the device back cover. Insert the net cable into the network port, then fasten the back cover.

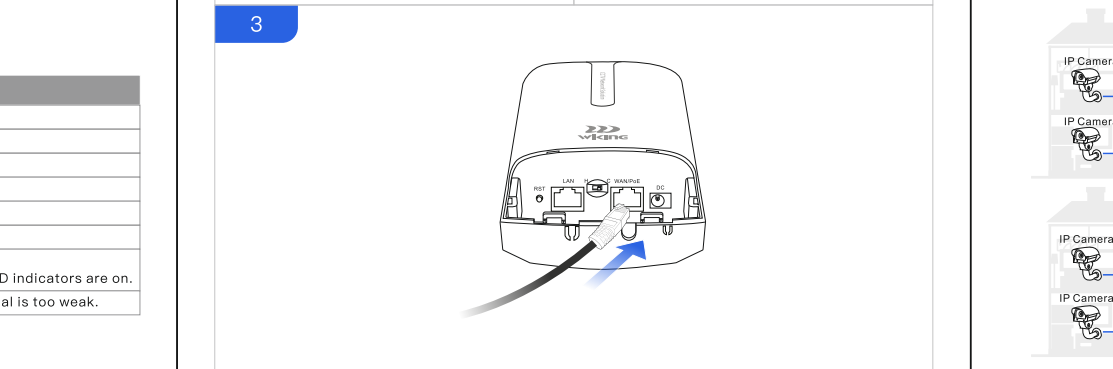
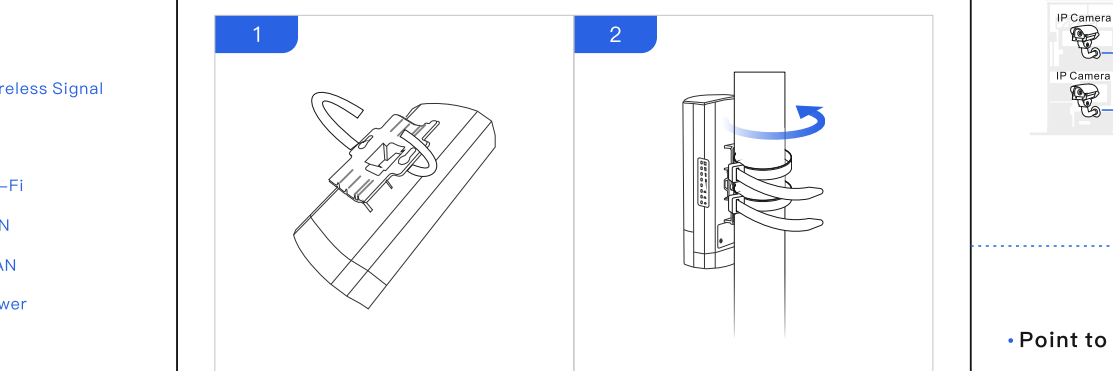

4.Network Application

•Point to Point Connection for CCTV

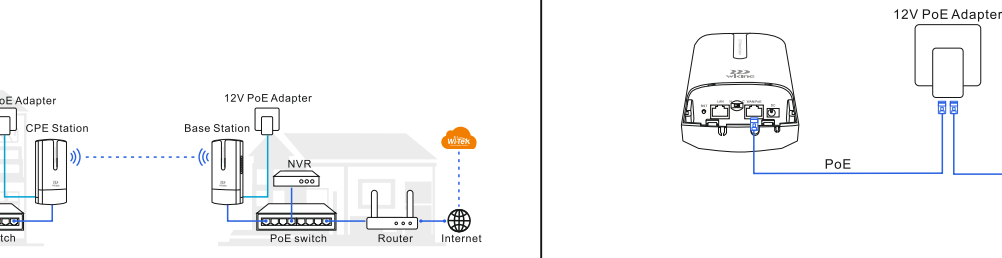

•Point to Multi-Point Connection for CCTV

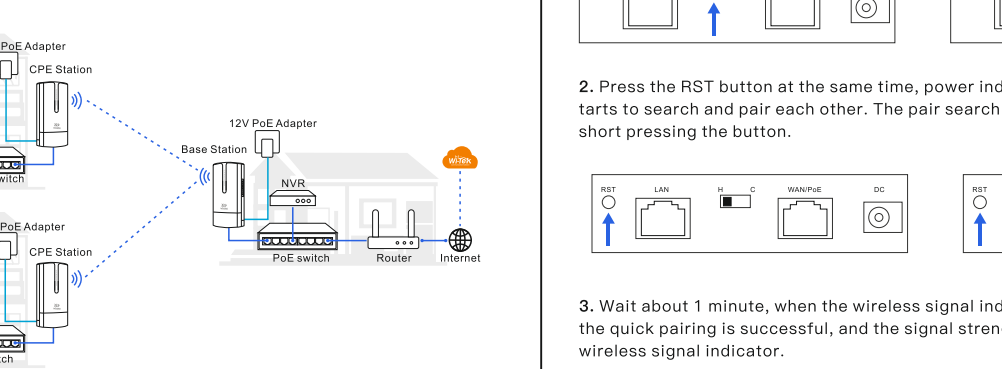

5. Quick Pairing

For PTMP application

1. Restore the devices that need to be added to the PTMP system.
2. Set the DIP switch to C (CPE) mode for the devices to be added and wait for restart to switching mode.



The device to be added

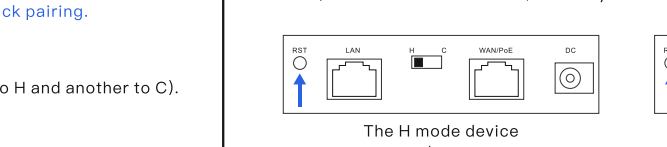

The H mode device in the PTP/PTMP system

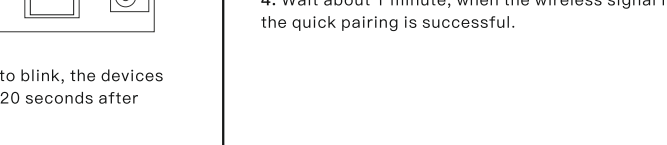

The device to be added



The device to be added

6.Management

Management by WEB

A) Set the device to Base Station Mode.

- Step 1. Set PC network IP to 192.168.1.X (X: 2-50), subnet mask: 255.255.255.0, same network segment as device. Launch the browser and enter the login page default IP: 192.168.1.88 or 192.168.1.89, set the administrator password.

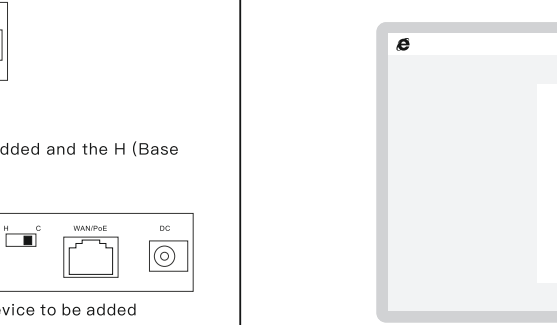

Step 2. Go to the "Wizard" page, select <Base Station Mode>, and click <Next>.

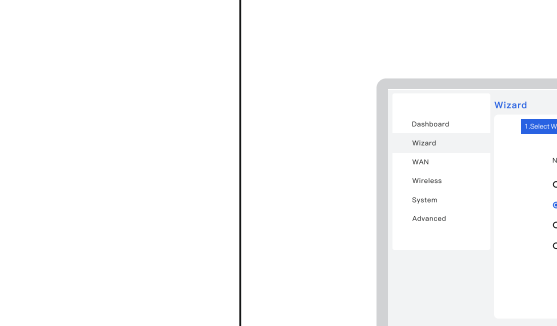

Step 3. Select the network protocol based on the network design. For example, select <Dynamic IP(DHCP)> and click <Next> in the "Select Network Protocol" page. Type in network parameters in the "WAN configuration" page, and click <Next>.



7. Cloud Management

Make sure your device has access to the Internet. Enter https://cloud2.wireless-tek.com in the browser and log in to the cloud, add a network, or select the existing network. Go to "Device MAC", click <ADD DEVICE >, enter the device's SN and last six hexes of device MAC address, and click <ADD >. Wait a moment, you can find it in the device list and view it in "Topology".

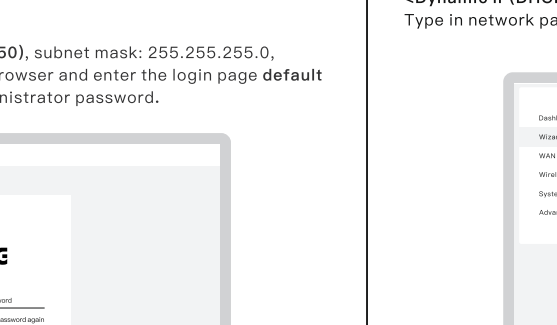

Step 4. Repeat the A) step 1, login the management WEB. Go to the "Wizard" page, select <Base Station Mode>, and click <Next>.

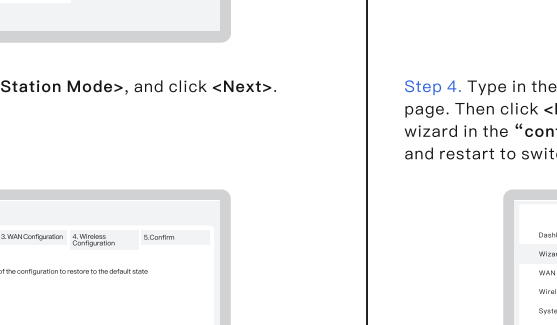

Step 5. Repeat the A) step 1, login the management WEB. Go to the "Wizard" page, select <Base Station Mode>, and click <Next>.

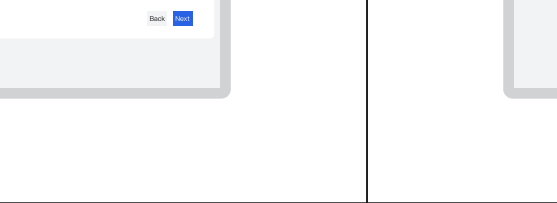

8.Warranty Card

Username	
Address	
Telephone No.	
Purchase Shop	
Purchase Address	
Product Model No.	
Purchase Time	
Serial No.	
Dealer Signature	

- If the product defects within the warranty period, we will provide professional maintenance service.
- Proof of purchase and a complete product serial number are required to receive any services guaranteed as part of the limited warranty.
- Any other defects that are not caused by workmanship or product quality, such as natural disasters, water damage, extreme thermal or environmental conditions, sticker damaged, warranty card loss will disqualify the product from limited warranty.

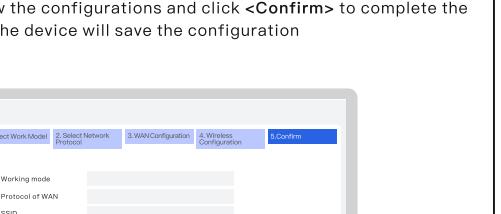

Company Website Cloud Management Technical Support

Wireless-Tek Technology Limited
Address: Building 3, Units 1801-1807, 1812, Huaqiang Era Plaza, Tangwei Community, Fuhai Street, Bao'an District, Shenzhen City, Guangdong Province, China.
Website: www.wireless-tek.com
Tel: 86-0755-32811290
Email: sales@wireless-tek.com
Technical Support: tech@wireless-tek.com

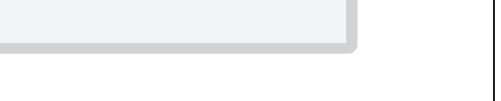

9.Quick Pairing

For PTMP application

1. Restore the devices that need to be added to the PTMP system.
2. Set the DIP switch to C (CPE) mode for the devices to be added and wait for restart to switching mode.



The device to be added

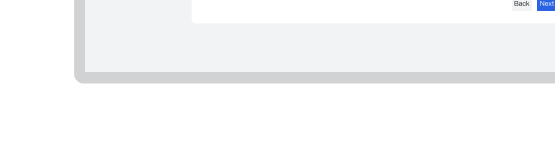

The H mode device in the PTP/PTMP system

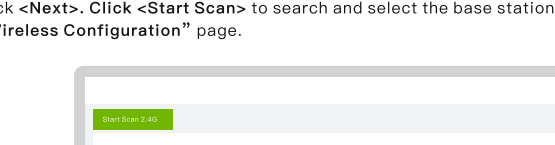

The device to be added

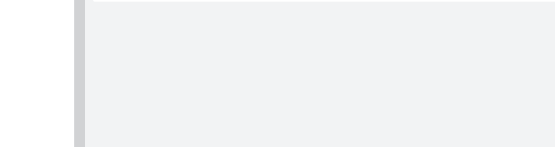

The device to be added

10.Quick Pairing

For PTP application

1. Set the DIP switch of the two devices to different modes (one to H and another to C), and wait for restart to switching mode.

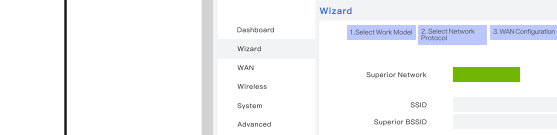

The H mode device in the PTP/PTMP system



The device to be added

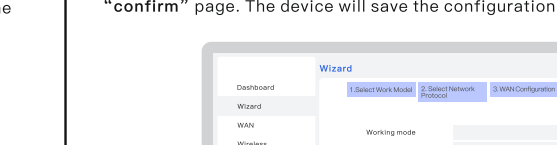

The device to be added



The device to be added

11.Quick Pairing

For PTMP application

1. Restore the devices that need to be added to the PTMP system.
2. Set the DIP switch to C (CPE) mode for the devices to be added and wait for restart to switching mode.



The device to be added



The H mode device in the PTP/PTMP system



The device to be added

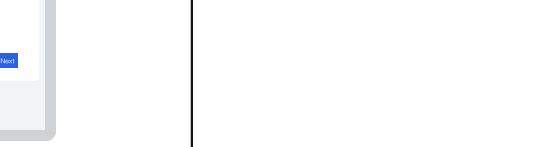

The device to be added

12.Quick Pairing

For PTP application

1. Set the DIP switch of the two devices to different modes (one to H and another to C), and wait for restart to switching mode.



The H mode device in the PTP/PTMP system

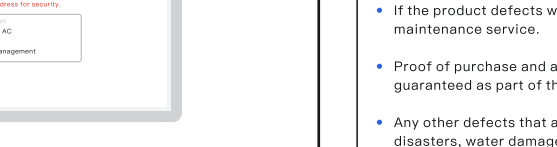

The device to be added



The device to be added

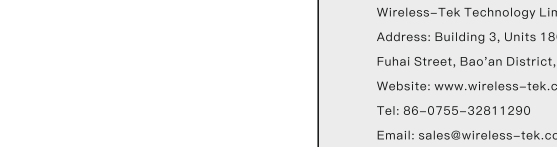

The device to be added

13.Quick Pairing

For PTMP application

1. Restore the devices that need to be added to the PTMP system.
2. Set the DIP switch to C (CPE) mode for the devices to be added and wait for restart to switching mode.

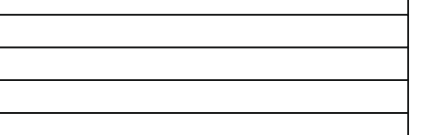

The device to be added

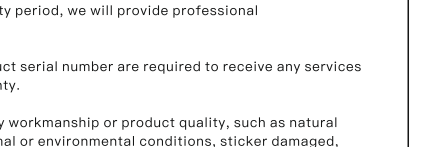

The H mode device in the PTP/PTMP system

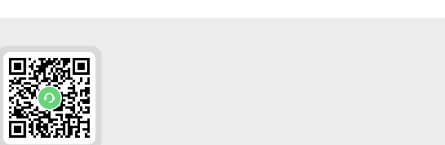

The device to be added

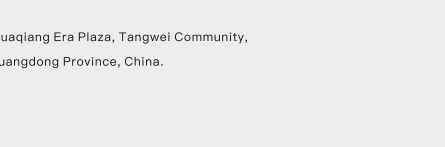

The device to be added

Finish the above steps and wait for the device to restart. The PTP application configuration is complete when the signal strength indicators of both devices are on. If you want to configure the PTMP application, repeat steps B) 5 - 8 for the other device after completing the PTP application.