



Quick Installation Guide

Cloud-Managed Wireless Ceiling Access Point



Wi-AP219AX

www.wireless-tek.com

1. Packing Content



1 x AP

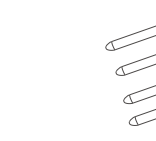

4 x Plastic Anchor



4 x Self-Tapping Screws

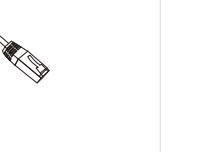

1 x Ethernet Cable

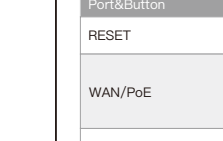

1 x Quick Installation Guide

2. Appearance Overview

• Wi-AP219AX

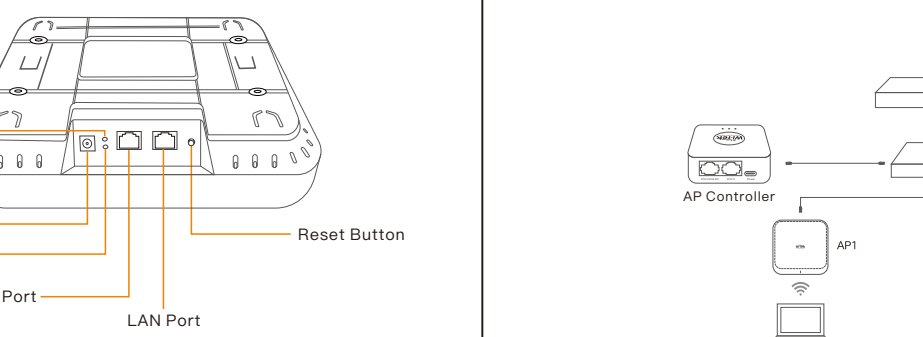

• LED indicator

| LED Indicators | Status | Description |
|------------------|------------|---|
| System Indicator | Red light | The system is starting. |
| | Blue light | The system is restoring factory. |
| | Blue light | The system is working normally. |
| LAN Indicator | Yellow | The LAN port is connected via Ethernet cable. |
| | Off | The LAN port is disconnected. |

• Port and Button

| Port&button | Description |
|-------------|---|
| RESET | Reset button, which is used to restore the factory. Holding down the reset button for 10 seconds to revert to factory settings. |
| WAN/PoE | 2.5Gbps Base-T Ethernet Port, which supports 802.3at PoE input. If the AP is powered through PoE, please connect this port to the PoE switch supporting 802.3at output. It is generally connected to the upstream switch. |
| LAN | 2.5Gbps Base-T Ethernet port. It is generally connected to wired LAN devices such as PC. |
| DC | DC Input: 12V, 2A. The AP is powered through 12V DC Input. |

3. Typical Connection

• Bypass mode topology

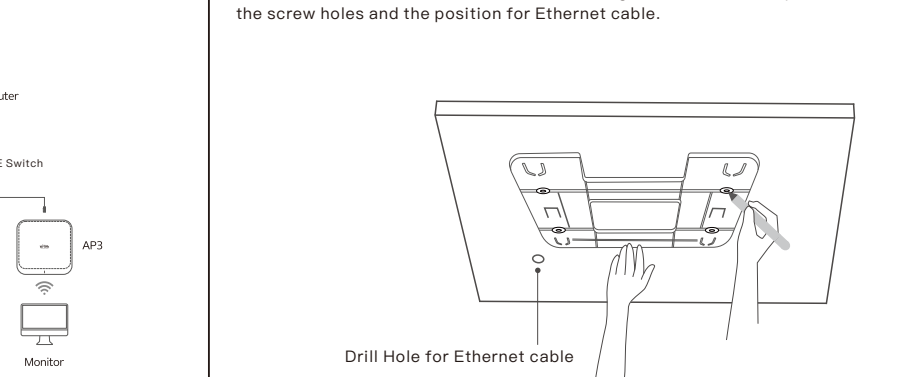

• AC Gateway mode topology

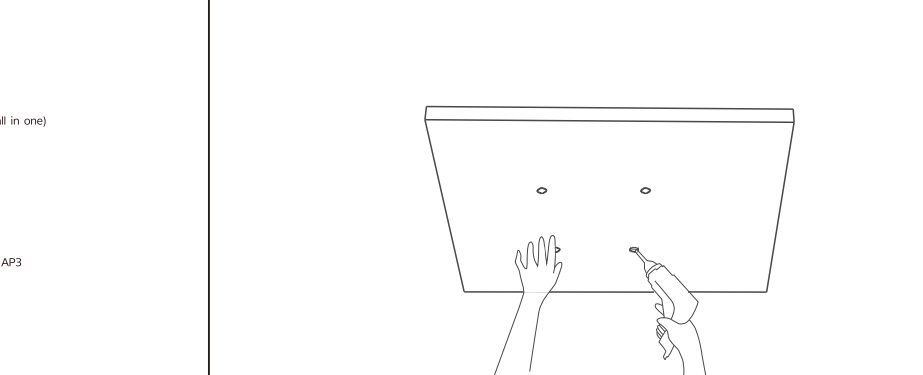

4. Device Installation

• Ceiling Mounting

- 1. Place the bracket in the center of the ceiling and then mark the positions for the screw holes and the position for Ethernet cable.

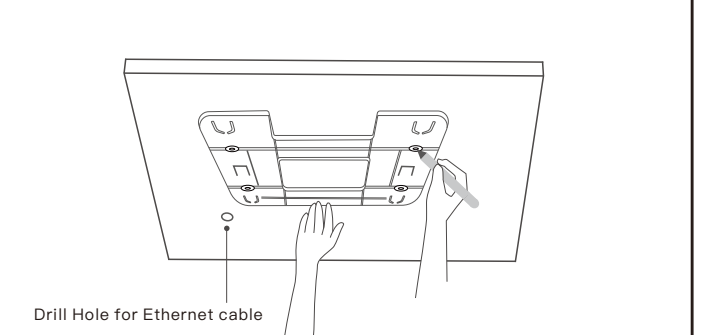

Drill Hole for Ethernet cable

- 2. Drill holes in the marked positions using a hammer drill

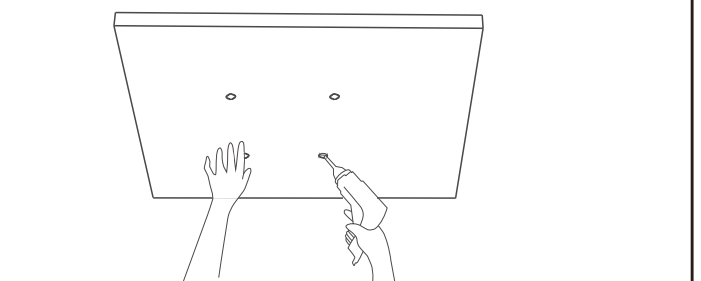

Drill Hole for Ethernet cable

• Power via PSE Device

- The APs can be powered via PoE switch which supports 802.3at PoE output.

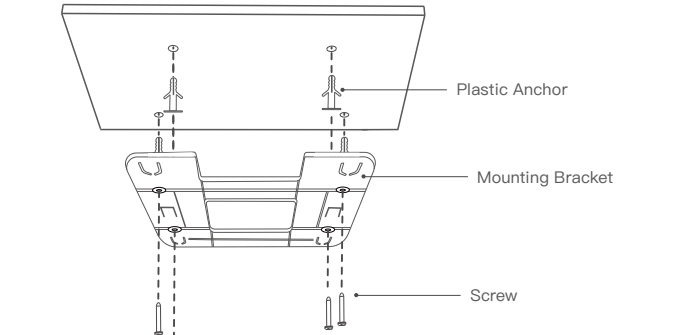

• Power via Power adapter

- Some APs can be powered via power adapter which supports 12V DC output.

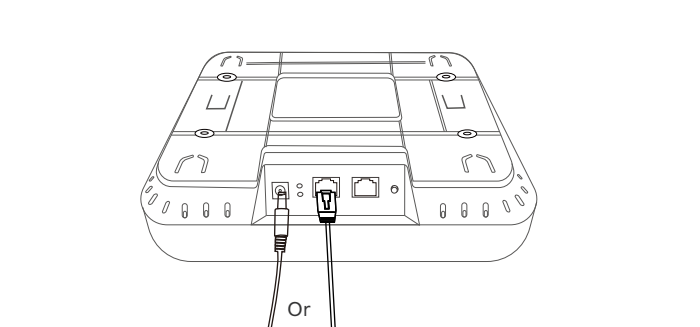

5. Power Supply

• Power via PSE Device

- The APs can be powered via PoE switch which supports 802.3at PoE output.

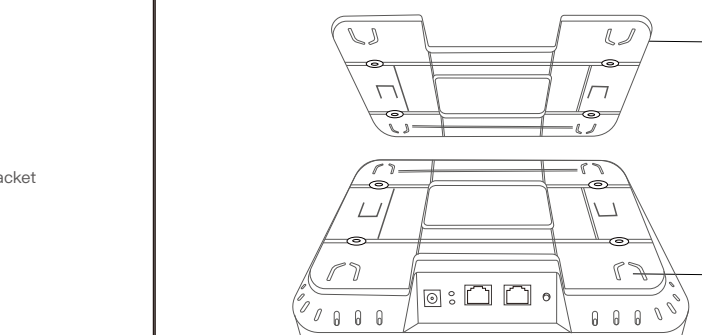

• Power via Power adapter

- Some APs can be powered via power adapter which supports 12V DC output.



6. Configuration Method

Method 1.

Connect computer to the wireless signal of AP, the default SSID is "Wi-Tek xxxx". Password is 88888888

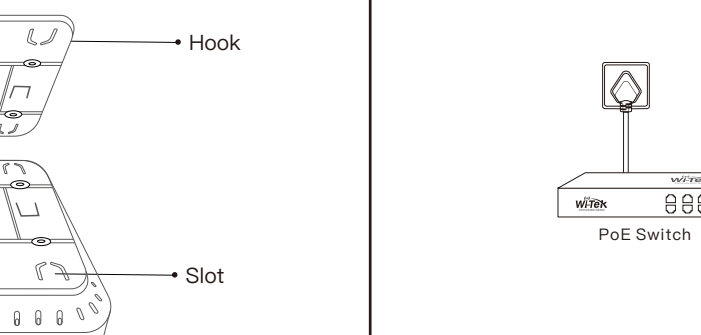

Method 2.

Connect computer to the AP by Ethernet cable.

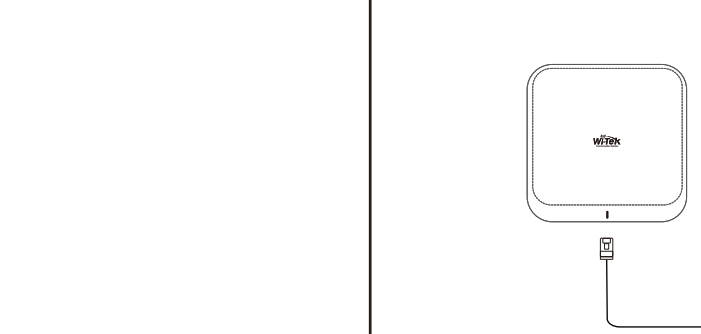

Step 1. On the computer, please set the static IP under the same subnet with AP, 192.168.1.xx

Step 2. Please launch a browser such as Google Chrome or Firefox, type 192.168.1.88 into address bar and click on enter to get in the login page of wireless access point. The default login password is "admin".

*Login device



Step 3. After get in the management page, On the left side menu, please go to [Wizard] to setup the access point

7. Cloud management settings

Step 1

Launch your web browser then enter http://cloud2.wireless-tek.com in the address bar.

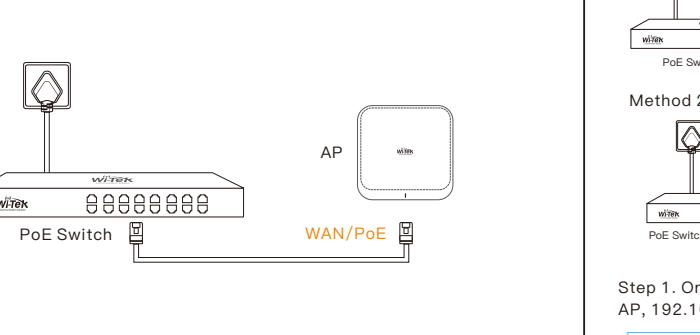

Step 2

Register an account password by user name or email.

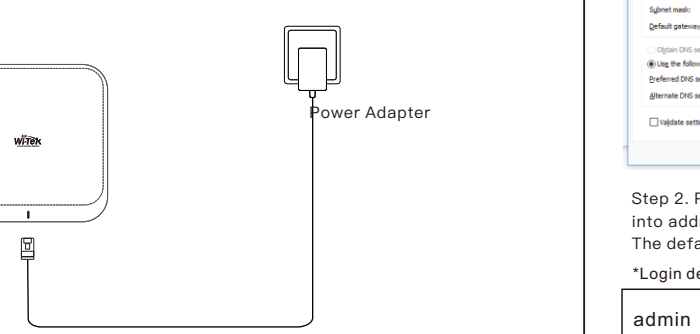

Step 3 log in to the cloud account with the account password after registration.

Step 3 log in to the cloud account with the account password after registration.

Step 3 log in to the cloud account with the account password after registration.

8. FAQ

Q1. The LED is not lit.

A1: Please check the PoE switch is 802.3at/at.

A2: Make sure the PoE switch is outputting the correct voltage.

A3: Make sure the Ethernet cable does support PoE function.

Q2. What can I do if the login window does not appear?

A1: Please check if the computer is the static IP 192.168.1.xxx.

A2: Please try another browser.

A3: Reboot your AP device and try again.

A4: Disconnect the Internet connection and try again, after login, connect to the internet.

9. Warranty Card

Warranty Card

| | |
|-------------------|--|
| Username | |
| Address | |
| Telephone No. | |
| Purchase Shop | |
| Purchase Address | |
| Product Model No. | |
| Purchase Time | |
| Serial No. | |
| Dealer Signature | |

*If the product defects within three months after purchase, we will provide you a new product of the same model.

*If the product defects within the three-year warranty period, we will provide the professional maintenance service.

*Proof of purchase and a complete product serial number are required to receive any services guaranteed as part of the limited warranty.

*Any other defects that are not caused by workmanship or product quality, such as natural disasters, water damage, extreme thermal or environmental conditions, sticker damaged, warranty card losing will disqualify the product from limited warranty.

Technical Support

Company Website

Cloud Management

Wireless-Tek Technology Limited

Address: Biao'an Technology Building 402, Bao'an street.

Bao'an District, Shenzhen City, Guangdong, China

Website: www.wireless-tek.com

Tel: 86-0755-32811290

Email: sales@wireless-tek.com

Technical Support: tech@wireless-tek.com

CE FC RoHS UK CA

CE FC RoHS UK CA

CE FC RoHS UK CA

10. Cloud management settings

Step 1

Click ADD NETWORK

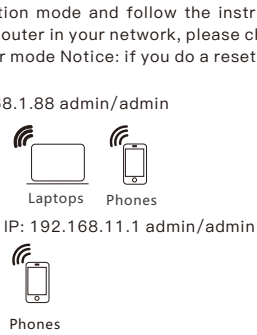

Step 2

Fill in the group name and location, click save.

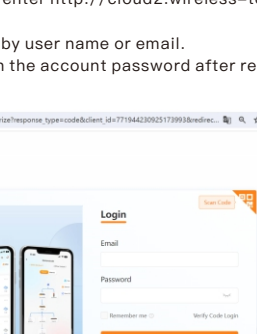

Step 3

Click Tunnel, Select binding device type, click EWEB to log in to the device.

Click Tunnel, Select binding device type, click EWEB to log in to the device.

11. Cloud management settings

Step 4

Select the appropriate operation mode and follow the instruction of wizard to finish the settings. If already exist a Router in your network, please choose, Fit AP mode; if not, you can choose Wireless Router mode Notice: If you do a reset, AP will recovery to Fit AP mode

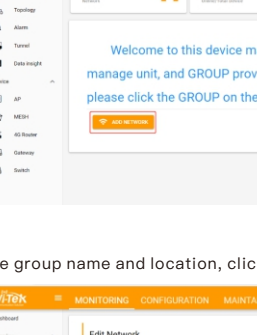

Step 5

In the relevant device options, you can see the bound device information.

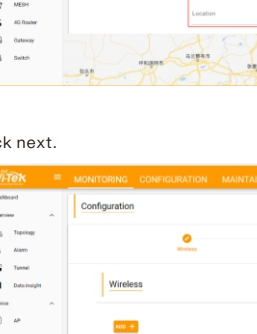

Step 6

Click Tunnel, Select binding device type, click EWEB to log in to the device.

Click Tunnel, Select binding device type, click EWEB to log in to the device.

12. Cloud management settings

Step 1

Launch your web browser then enter http://cloud2.wireless-tek.com in the address bar.

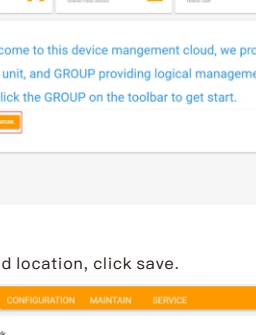

Step 2

Register an account password by user name or email.

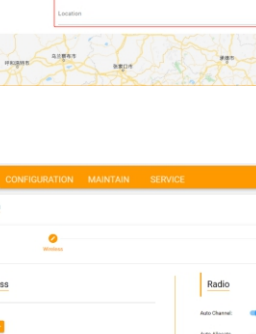

Step 3 log in to the cloud account with the account password after registration.

Step 3 log in to the cloud account with the account password after registration.

Step 3 log in to the cloud account with the account password after registration.

13. Cloud management settings

Step 4

Select the appropriate operation mode and follow the instruction of wizard to finish the settings. If already exist a Router in your network, please choose, Fit AP mode; if not, you can choose Wireless Router mode Notice: If you do a reset, AP will recovery to Fit AP mode

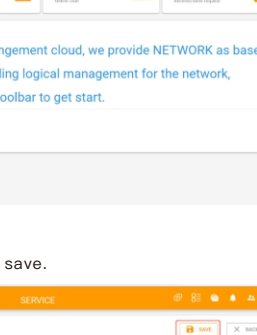

Step 5

In the relevant device options, you can see the bound device information.

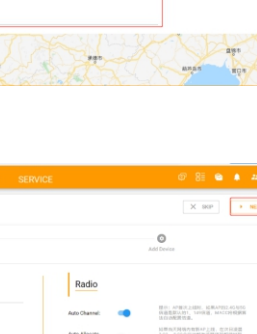

Step 6

Click Tunnel, Select binding device type, click EWEB to log in to the device.

Click Tunnel, Select binding device type, click EWEB to log in to the device.

14. Cloud management settings

Step 1

Click ADD NETWORK

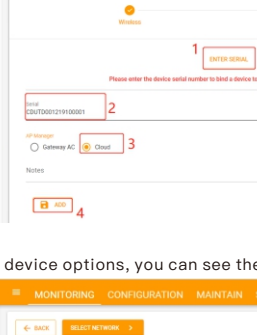

Step 2

Fill in the group name and location, click save.

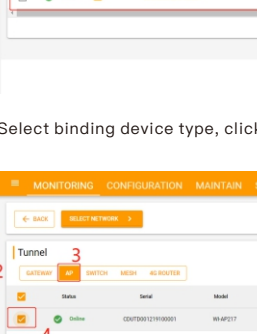

Step 3

Click Tunnel, Select binding device type, click EWEB to log in to the device.

Click Tunnel, Select binding device type, click EWEB to log in to the device.

15. Cloud management settings

Step 4

Select the appropriate operation mode and follow the instruction of wizard to finish the settings. If already exist a Router in your network, please choose, Fit AP mode; if not, you can choose Wireless Router mode Notice: If you do a reset, AP will recovery to Fit AP mode

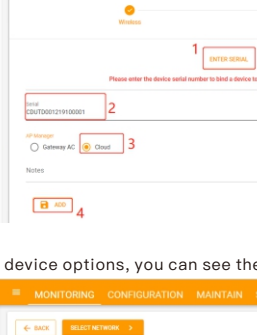

Step 5

In the relevant device options, you can see the bound device information.

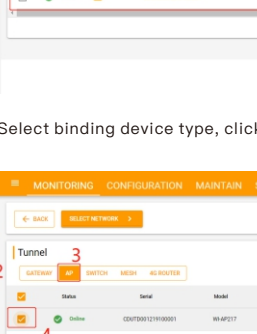

Step 6

Click Tunnel, Select binding device type, click EWEB to log in to the device.

Click Tunnel, Select binding device type, click EWEB to log in to the device.